

ECCLES STATION

NEWS

JUNE 2013

The contents of this month's e issue are as follows:

News section. Articles. Trip of the month. Book Review

*We have a reminder of **engineering work** that will be taking place on the L&M line, plenty of news, and a photographic look at an obscure but attractive area of the North West. Space constraints and a shortage of staff in the research section means that a proposed review of Dr Beeching's legacy will be held over to next issue. **Editor***

NEWS

There have been some changes to the **Northern Hub proposals**. A timetabling exercise has shown that the introduction of electric trains will increase line capacity rendering some of the civil engineering proposals unnecessary. The **Liverpool & Manchester line will now be quadrupled between Huyton and Roby only**, and the quadrupling of the Manchester Huddersfield line between Saddleworth and Marsden will not take place.

*The plan for the western facing bay platforms at **Manchester Victoria** has been dropped. More trains from the west will run through and terminate at Stalybridge and Rochdale instead. This will give even better services to these two towns and create the space for extra trains at Victoria.*

The demolition work at Manchester **Mayfield** has now stopped (paused?). Apparently the proposed civil service accommodation will not be built. The overall roof and most of the side walls have been removed. The space created will now be used as a major venue for the **2013 Manchester International Festival in July**. For details of the many events scheduled to take place there see http://www.mif.co.uk/Downloads/press_releases/Mayfield_Depot_FINAL.pdf

*At Manchester Piccadilly the current platforms 13 & 14 will not be replaced as part of the Northern Hub work. An additional viaduct will be constructed by the side of these platforms to provide the **new platforms 15 & 16**. Oxford Road Station will also see considerable expenditure to give four long, fully accessible through platforms. Full details are not yet planned out but the station will need to occupy more ground area, and the listed parts of the buildings will be retained.*

The electrification engineering work means that **Eccles trains will be replaced by buses on Sundays** up to and including Sunday 8th July 2013. This also applies on Saturdays 1st and 22nd June.

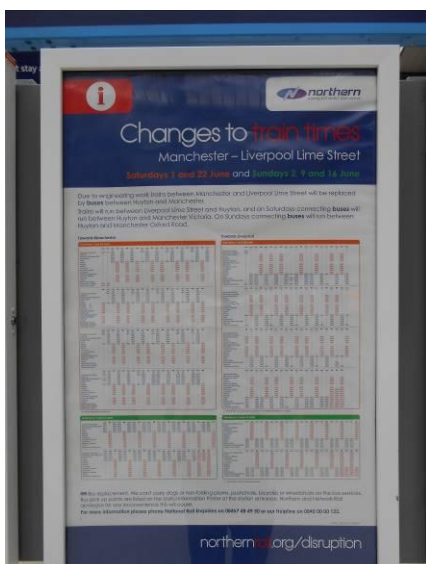

A bus will run from Piccadilly to Huyton through Eccles. Zoom the picture to see the replacement bus timetable.

The portals are up at Eccles Station, and catenary wiring has now reached Eccles.



At Eccles the wiring seems to have got ahead of the provision of insulators and supports, so in a number of places it is hung temporarily on nylon straps with pulleys.

Notice that the load bearing part of the wiring is actually a copper rope with a steel strand twisted in for strength. Trains will draw energy from the copper wire below it.





Network Rail has cleared many trees that would have been too close to the wiring. At Eccles station this has exposed much that we would rather had remained hidden!

Therefore a lot of clearing up needs to be done urgently by Freccles at the monthly work day.

Roy Chapman, the Rail Services planning officer at Transport for Greater Manchester (TFGM) has written to **Steve Clapham of Freccles** thanking us for undertaking the survey of passengers published in last month's edition of ESN. He points out that the data confirms the views of TFGM that Customer information screens, CCTV and Help points should be priorities for Eccles as soon as funding is available. However he says 'Whilst we note that many passengers want longer ticket office hours, this is a common request across Greater Manchester. However, such extensions to hours are difficult to justify **as they add to railway costs.**'



BT Police Constable 411, Maxine Southwell visited Eccles, on the 16th May as a result of the latest incident of fly tipping at the usual spot. Unfortunately there was nothing of evidential value among the rubbish.

Network Rail has now removed a lot of rubbish following the tree felling so the area looks rather better!

The tulips in the station garden are looking wonderful. Here are those in the wave on the Liverpool platform. Many thanks to our gardening team for maintaining such good displays.

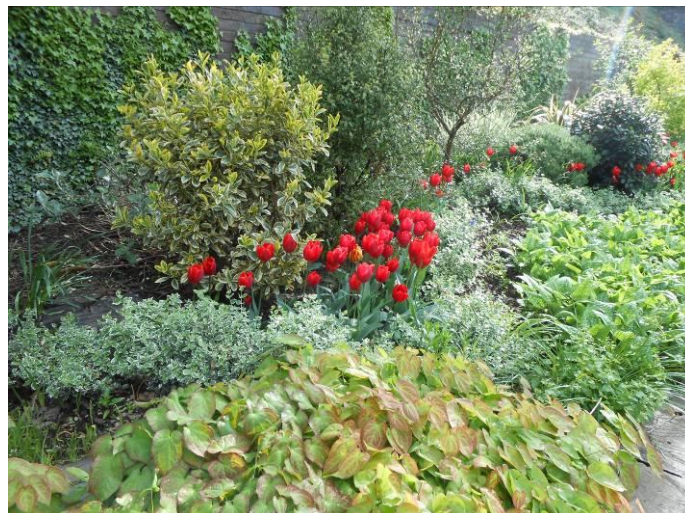

And let's not forget the tubs:



***The next gardening and station cleaning day is on Sunday 7th July at 11.00.
Join the team for a pleasant couple of hours exercise.***

The students of Manchester University are holding an arts festival in early June. Take a look at the web site quoted on the poster below for a feast of music and drama:



OUT AND ABOUT...



This is a view from the platform at Foxfield Station between Barrow and Millom on the west coast of the Lake District. The old water tower is still in place.

The white building is a pub called The Prince of Wales. It houses its own brewery and contributes significantly to passenger demand for this station (there are not many houses at Foxfield!)

Yes it is one of those wretched beer festivals that the Prince of Wales keeps holding. This food and drink marquee was in the pub garden. Beers (porters, stouts and dark milds) from small breweries throughout the UK were on sale.



This is the view from the waiting room at Foxfield Station. It overlooks the Duddon Estuary and salt marshes.

The next station along the line is lovingly cared for by volunteers. You have to ask the guard to stop the train there if you want to get off.



It is a lovely spot. Here is a view along the line from Green Road Station back towards Foxfield



A snap taken from a bridge on Green Road on the way to the village about $\frac{3}{4}$ mile from the station.



The pub on the green at the village is called The Punch Bowl and is the home of the tiny Beckstones Brewery.

The pub was **closed until 18.00** but the walk had been lovely!

The whole area is lovely and deserves to be better known. It is a long journey to get there but well worth a visit, especially if you have a rover ticket for a few days.



Spotted while waiting for the train back, some of the nest boxes provided under the canopy are actually occupied by flying things (black and white with forked tails).

All photos by JE Rayner.

...By TRAIN from ECCLES STATION.

ARTICLES

MORE ON GROWTH FIGURES.

Eccles is not the only station in Greater Manchester showing **spectacular growth in passenger numbers**. Freccles member **Sean Dunne** has sent in the following data showing that 8 stations did even better in percentage terms!

Station	%growth	passengers usage
Clifton	193%	498
Manchester Victoria	56%	9,829,488
Belle Vue	36%	19,970
Fairfield	33%	21,234
Hall I' Th' Wood	27%	109,652
Manchester Oxford Road	26%	8,321,622
Moston	26%	139,512
Swinton	26%	153,452
Eccles	23%	149,336
Farnworth	21%	44,716

Of course some of the stations have started from very low passenger numbers but Eccles, along with Swinton and a couple of others have demonstrated growth on passenger figures already in the 100.000+ bracket.

The growth figure for Manchester Victoria is very interesting. At 56% it is much higher than the growth rate taken across all the greater Manchester Stations. It seems unlikely that this is a transfer of passengers from Piccadilly or Oxford Road Stations as they have good growth as well. It would seem that large numbers of passengers have started to travel between Manchester Victoria and stations outside the Greater Manchester boundary.

Piccadilly Photography Exhibition

Five of the country's biggest and busiest railway stations will become art galleries this summer, hosting a special exhibition of stunning images from the

Take-a-view Landscape Photographer of the Year competition. Visitors will also have the opportunity to get expert advice from celebrated landscape photographer and founder of the competition, Charlie Waite. Each exhibit will showcase a series of stunning previously commended entries of places which can be reached by the host city's railway, and give details of how to reach them by rail. Visitors can also find out how to enter the Landscape Photographer of the Year competition, which has a top prize of £10,000 and includes a separate 'Lines in the Landscape' award which seeks to find the best railway-related photography.



The exhibition will start off at Manchester Piccadilly on Saturday 8 June until Saturday 15th. The next week it will go to Leeds and then to Glasgow Central, King's Cross and finally London Waterloo.

On the Monday of each exhibition between 11am and 2pm, visitors to the stations can bring their cameras, phones, tablets and anything else that has a photograph on it, for the chance to get some commentary, feedback and advice from Charlie Waite. There will also be chances to win a copy of the Landscape Photographer of the Year book (RRP £25).

Why should Network Rail host exhibitions such as this? David Biggs of Network Rail said "People don't just want their stations to be places they catch their trains from; they want to shop, eat, drink and enjoy their surroundings. Our stations are natural exhibition spaces so ... **Take-a-view** seemed a natural fit. We also hope that passengers will be inspired to visit the fantastic places they can reach by rail."

For competition entry details visit www.take-a-view.co.uk

TRIP OF THE MONTH.

An attractive river and country walk with some great views. The trip is Number **Eighty two:**

MARPLE – STRINES – NEWMILLS.

This is an attractive stroll along the Goyt Valley. (For a very easy short walk go as far as Strines Station - trains back to Manchester every two hours so time your walk right). After Strines there is a relentless ascent to Brookbottom (the pub might be open!) followed by wide open views on the quiet lane to New Mills.

Take the train to Manchester Victoria and from there a tram to Manchester Piccadilly Station. From here catch a train to Marple (NOT Rose Hill). *Option: - turn right as you get off the tram and on Fairfield Street use the lift on the left to the link bridge lounge.*

STAGE I

Alight at Marple Station. Go down the short approach road and turn left to Marple Bridge. *Marple Bridge is an attractive stone village. The Midland is a free house selling cask marque real ales, tea, coffee, snacks and full meals.*

Cross the bridge *over the River Goyt* and turn right past the shops (*The Royal Scot sells Robinson's real ales*).

Fork right onto Lower Lea Road, and follow this. *At the top of the gentle rise you see the hills ahead.*

Descend to a T with Lakes Road. Turn left along this.

Follow it to the right in front of Bottoms Hall (*Charmingly named, impressively sited - Georgian?*).

Next on the left are some lakes. *Called Roman Lakes they are used for boating and fishing –take a look.*

Pass under the railway viaduct. *On the right is a weir. On the left is an octagonal cottage – was it a toll house?*

Go through a long tunnel under the railway and pass a farm on the right. Then keep straight on. When you come to another farm turn right over a little bridge and immediately left.

The track next meets a setted road – go left (*signed Goyt Way*) to Strines Station. (*The timetable and Manchester platform are on the right*).

STAGE II.

Go under the railway and turn right uphill. *This seemingly endless climb is aside a narrow wooded valley.*

You emerge in the stone hamlet of Brookbottom (*which feels like it should be Brooktop!*) *On the left is The Fox Inn – Robinson’s real ales.*

Turn right past the old phone box. *A short way up here there is a view going Manchester to New Mills.*

Keep along this lane. *The view opens wider to include tracts of upland moors as you proceed.*

Eventually you start to descend into New Mills. Go right through a gap in the wall into a park.

Walk straight down and then left in front of the house in the centre (*elegant and restrained - Georgian?*).

Head towards the Church spire. (*from the school of Peak District rugged!*).

Turn right down St Mary’s Road. At the bottom cross Hague Bar Road and fork right down the lane opposite.

Then fork right onto new Mills Central station. Turn left over the footbridge for the Manchester platform and a train to Piccadilly.

CLASSIFICATION: STAGE I: SHORT EASY

STAGE II: SHORT MODERATE (one long climb).

COUNTRYSIDE, RIVER, PUBS, CAFE, VIEWS, WOODLAND.

RAIL FARE: £7.10 Buy a day return Eccles to Marple then pay a £3 single back from New Mills Central to Marple, or use the 60+ Peak Wayfarer ticket for entire journey.

MAP OS 1:50 000 sheet 109

Philip’s Street Atlas Greater Manchester

BOOK REVIEW:

'THE GREAT RAILWAY REVOLUTION. The Epic Story of the American Railroad'

by Christian Wolmar. ISBN 9780857897794

Atlantic Books £25.00

Christian Wolmar is Britain's best known railway journalist and has become a prolific author too. He writes with clarity and argues well so this book gives a clear, interesting narrative of the dramatic rise and fall of the railroads in the States.

With the aid of the generous land grants the USA became the greatest railroad nation with over a quarter of a million route miles in 1916, and this network liberated the vast productive forces of that country; allowed the development of the huge cities, and changed the lives and fortunes of all the inhabitants (results less than positive for the native Americans!).

Of course in such an industry vast fortunes were for the making and inevitably some of these were realised by less than honest means, resulting in a bad political reputation for such a vital system. There followed over regulation, underinvestment, and union resistance to change of working practices. The railways were expected to remain private, profit making, exceedingly safe and unsubsidised; meanwhile the state built national roads and promoted air travel. (Does all this sound familiar somehow?). The America government spends more in a year on roads than it has spent in total on Amtrack since 1971). This situation is still not resolved in the USA although there does seem to be a return to rail travel taking place across the pond too.

There are two interesting black and white picture sections.

This new book has not been purchased by Eccles Library (you know why), but is available on inter-library loan and well worth a read.

To find out more about **FRECCLES** or to make contact see our **website:** www.freccles.org or e mail us at info@freccles.org.uk

